

Features & Benefits

- 4 Star energy efficiency
- Mains pressure at multiple taps
- Easy replacement – common fittings with standard 3 & 4 Star models
- Two anodes
- Natural and propane gas model
- 10 year cylinder warranty¹

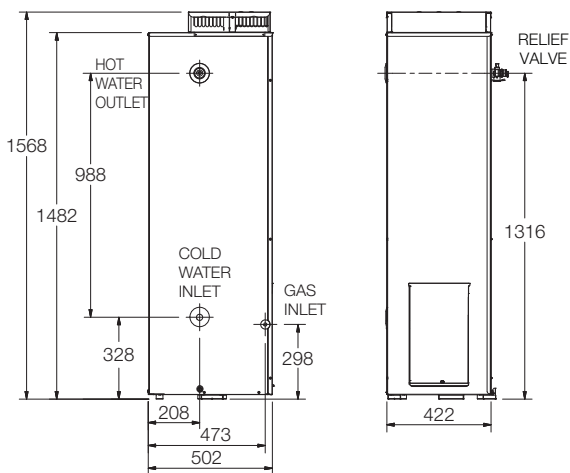

| MODEL | 347135 |
|-----------------------------------|--------------------------------|
| Storage Capacity (L) | 135 |
| Hourly Recovery (L) | 113 |
| Gas Consumption (MJ/Hr) | 27 |
| Relief Valve Pressure (kPa) | 1400 |
| Expansion Control Valve (kPa) | 1200 |
| Max Water Supply Pressure: | |
| with ECV (kPa) | 960 |
| without ECV (kPa) | 1120 |
| Water Connections | Rp ³ / ₄ |
| Gas Connection | Rp ¹ / ₂ |
| Approx. Weight (packaged) kg | 69 |



Tap QR code for installation instructions

